

Watson Arts Centre

1 Aspinall Street, Watson

MAIL: PO Box 7021, WATSON, ACT 2602

PHONE/FAX: (02) 6241 1670

E-MAIL: wcac@canberrapotters.com.au

WEB: <http://www.canberrapotters.com.au/wcac.html>

APPLICATION FOR STUDIO SPACE

Canberra Potters' Society is a not-for-profit organisation supported by the ACT Government. It manages Watson Arts Centre, which is an ACT Government facility. Apart from the Society's workshops, gallery, shop and other space, the Centre has three studios providing affordable space for emerging and established ceramic artists.

The objectives of the Society are to:

- promote excellence and innovation in ceramics—foster and facilitate contact between people interested in ceramics; promote the exchange of ideas and the dissemination of information on ceramics; mount selected exhibitions of members' work;
- foster appreciation of handcrafted ceramics in the broader community—conduct classes; mount exhibitions; participate in public art activities;
- encourage the professional development of its members—provide support and facilitate the professional development of members who are working as potters; provide facilities for members to exhibit and sell their work; run specialist workshops for skills development;
- be a key part of the national network of ceramic organisations.

Applications for studios are invited from all committed ceramic arts practitioners. Because the Centre only has a few studios to rent, a high degree of professionalism and commitment to studio practice is expected from tenants so that the benefit and use of the studios are maximised. Tenants are also expected to become full members of Canberra Potters' Society (and to remain so whilst tenants) and to participate in Society activities.

The studios open onto a shared verandah. As this verandah is visible from the gallery and is often used during exhibition opening events (as well as for other Society events and by Society members, students, etc.) tenants are expected to keep the verandah in a clean and tidy state at all times and must not use the area for storage of equipment, materials, etc. The three studios have running water and sinks but no clay traps. There is no 3-phase power supplied to any of the studios. There is ample car parking space at the front of the building; vehicles may be driven round to the back of the site close to the studios when required.

When applying for studios, potential tenants will need to discuss any kiln requirements they may have. The Society has several kilns, but the electric kilns are heavily used and firing of student work always takes precedence. It may be necessary for kiln needs to be discussed with the Society's administrator.

Studio 1 is currently leased on an on-going basis to the Society's Administrator/Artist-in-Residence. **A second studio** is available generally on a one-year lease – a new application may be submitted towards the end of a lease period for consideration with any other applications. **A third studio** may be used for short-term lets with tenancy periods open to negotiation but with a minimum period of one month. Again, a new application may be submitted towards the end of a lease period for consideration with any other applications.

Although there is security monitoring to most areas of the premises, there is no security monitoring to any of the studios.

Studio availability is dependent on ongoing renewal of the lease Canberra Potters' Society has with the ACT Government and, to a lesser extent, on the Society receiving ongoing funding.

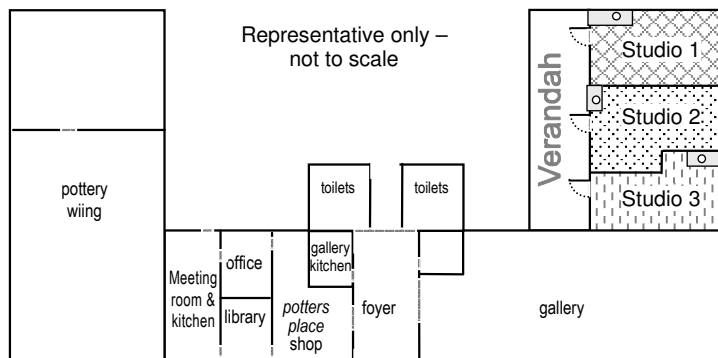

Office use only

Date received	Acknowledged	Interviewed
---------------	--------------	-------------



